



RETREAT

An escape from the scorch, embedded in the earth, the faint sense of light draws people inside.



Springdale Veterans War Memorial

The Springdale Veterans War Memorial seeks to provide a moment of repose for those who have fought bravely in service for the United States of America. Here individuals have the space to remember those who they have fought alongside and appreciate the freedom through their sacrifice.

REFUGE

A place for memory, light showers upon individuals as they stand in remembrance.



Green

The J.B. Hunt Park is one full of activity, and we see no reason why the Memorial can't be a part of that. Across from the plaza, the field has been preserved, along with a number of new plantings to encourage the use of the far east parts of the park.

Trail

An important part of the J.B. Hunt Park is its connection to the rest of Northwest Arkansas. The pathways around the park leading to the Greenway link with the plaza, engaging the Springdale Veteran Memorial with the rest of Northwest Arkansas.

Plaza

The Springdale Veterans Memorial's visitors are first greeted through a sloping plaza, drawing people off the paths and ushering them towards the memorial. A forced perspective draws individual's eyes to the threshold allowing people to enter.

Pool

An element for the senses, the pool catches people's eye during the day and at night through shimmers of light. The acoustical funneling of the retain walls will heighten the noise the pool makes as it slopes towards the memorial.

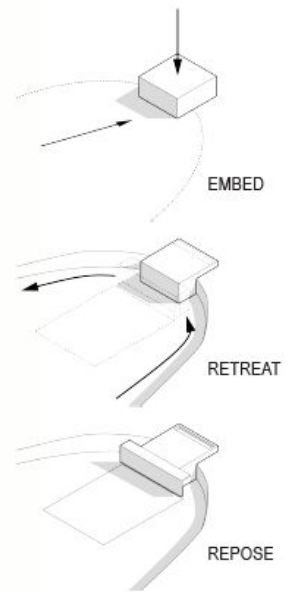

The Sacrifice for Peace



The Sacrifice for Peace, a memorial centered on sacrifice and community, exists within the larger designed landscape. Intending on being the primary focal point, the memorial itself focuses on two reflecting pools: one representing sacrifice, and the other representing community. Through the use of water, and the different forms that it can take, we sought to create a simple but moving experience for veterans and civilians alike.



David Sweere:

HOLLOW MONOLITHS: EFFEMERAL EXPERIENCE UNDER THE WEIGHT OF MEMORY

A MONUMENT IS MEANT TO BE IMPACTFUL, ENDURING, AND EVEN SPIRITUALLY MOVING THROUGH ITS TOTAL SENSORY EXPERIENCE. THE MONUMENT COMMEMORATING THE SILENT SACRIFICE OF VETERANS OF SPRINGDALE AND THE GREAT WAR CREATED AN ATMOSPHERE WHICH CHANGED ALL THE SONGS IN ITS HISTORICAL ATTACHMENT TO THE COLLECTIVE MEMORIES OF THE LANDSCAPE AS A SETTING FOR THE HISTORY OF MAN. THE MEMORY OF VETERANS IS ETCHED IN STONE IN THIS MONUMENT WHICH RATIONALIZED THE NATURAL CLIFFS AND CHANGING VEGETATION OF THE NEARBY OZARK NATIONAL FOREST.

NORTHWEST ARKANSAS DEVELOPED AS A SERIES OF SMALL TOWNS ALONG A HIGHWAY AND RAIL LINE NATURALLY SITUATED THROUGH THE MOUNTAINOUS FOREST, RIVERS, AND STREAMS OF THE BOZEMAN MOUNTAINS, A PLATEAU CARVED BY WATER OVER MILLIONS, REVEALING ITS REGIONAL FLAVOR IN STONE CLIFFS, WATERFALLS, AND NATURAL CAVERNS. IT'S A ROLLING AND RUGGED STONE LANDSCAPE BLANKETED IN A FARBROWED FOREST OF OAK AND PEECHY, CHANGING WITH THE SEASONS IN A YEARLY DISPLAY OF SPECTACULAR COLOR. THE MONUMENT BECAME PART OF THE NATURAL LANDSCAPE OF THE REGION, RESPECTING ITSELF AS A MODIFICATION OF THE GREAT MOUNTAINOUS FOREST OF NORTHWEST ARKANSAS, CHANGING ITS SENSORY EXPERIENCE CREATED BY TREE CANOPY AND ROCKY TERRAIN.

THE INTENT IS TO CREATE A TIMELESS PIECE OF ARCHITECTURE THAT SEEMS AS THOUGH IT BELONGS AS LONG AS THE NATURAL STONE FORMATIONS AND COVERING FOREST OF THE BOZEMAN MOUNTAINS. THE VETERANS OF THE GREAT WAR CAN OBSERVE A MONUMENT OF SHORT PERMANENCE.

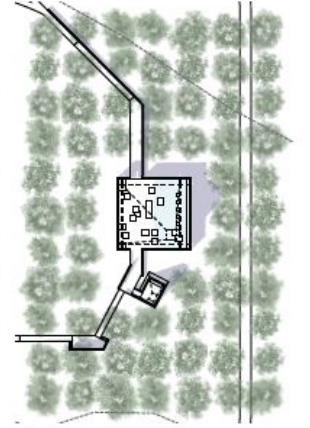
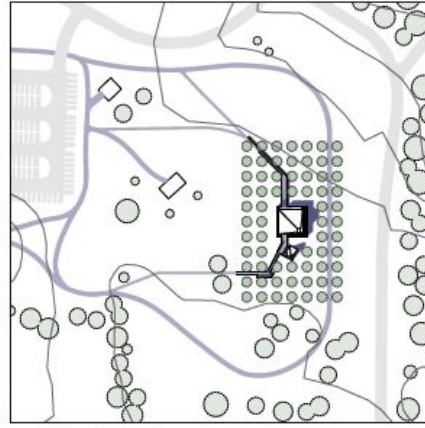
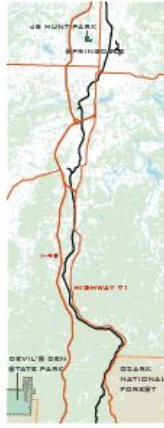

NATURAL CAVERNS + WATERFALLS OF NORTHWEST ARKANSAS | 0' 100' 200' | US HUNT PARK - EXTENDED BICYCLE PATHS + VETERANS MEMORIAL DRIVE | 0' 80' 100' | SPRINGDALE VETERANS MEMORIAL SITE PLAN



SENSORY EXPERIENCE:

THE EXPERIENCE BEGINS WITH A SLOW DESCENT ALONG A WALL OF LOCAL STONE, ENTERING UNDER THE CANOPY OF SHADY WHITE OAK TREES. THE SOUND OF WIND WHISPERING THROUGH LEAVES ABOVE, ECHOES OF NOTHING SOUNDS, AND SMELL OF OAK FILL THE AIR. THE LIGHT DRAMATICALLY CHANGES FROM EXTENSION TO INTERIOR OF THE MONUMENT, FORGING THE CYCLE TO ALIGHT UNDER THE CONCRETE ROOF AS THE SOUND OF TRICKLING WATER COMES TO THE FOREGROUND OF THE SENSORY EXPERIENCE. MEANDERING AROUND LARGE PILLARS OF LOCAL Limestone, THE SPACE OPENS UP TO A POOL OF BUBBLING WATER AND FIVE BLACK STONE COLUMNS, EACH REPRESENTING A BRANCH OF THE US MILITARY, OBSERVED WITH THEIR OFFICIAL SIGLS. INDIRECT LIGHT MARKS THE STONE WALL BEHIND THE COLUMNS AS A NATURAL SPILLWAY FROM THE ISSUES ABOVE SPRING DOWN ON TRICK. PLATES OF STEEL ATTACHED TO THE LIMESTONE PILLARS REPRESENT WARS THAT ARKANSAS VETERANS HAVE Fought AND PARTICIPATED IN, CREATING A SOMBER, CONTEMPLATIVE TONE THROUGHOUT THE SPACE.

FOLLOWING THE MONUMENT IS A COMPLETE CHAPEL, DARKER AND HARMONIC THAN THE LATTER. THE ARCHES OF FLOWERS FILL THE SPACE AND PETALS COVER THE FLOOR. UNDER THE GLOWING CONCRETE CEILING, A STEEL PLATE FIXED ON THE WALL HAS 10,000 SQUARE OPENINGS, LARGE ENOUGH TO FIT THE OUCH OF ONE FLOWER, EACH REPRESENTING 100 OF THE 1.1 MILLION AMERICAN LIVES LOST IN WAR OVER THE COURSE OF OUR NATION'S HISTORY.

FINALLY, THE PATH CONCLUDES WITH A MOMENT OF STILLS TO THOSE WHO HAVE DONATED TIME AND FUNDS TO MAKE THE MONUMENT POSSIBLE. A STONE WALL PLAYED IN STEEL LISTS THOSE WHO PLAYED A PART IN ITS MAKING AND DESCRIBES ITS ARCHITECTURAL STORY.



MEMORIAL LIMESTONE PILLAR + BLACK SOAPSTONE ENGRAVING ELEVATION



CHAPEL FLOWER WALL STEEL PLATE ELEVATION - 10,000 OPENINGS



GRATITUDE WALL STEEL PLATE ELEVATION



MEMORIAL ENTRY VIEW



CHAPEL INTERIOR VIEW



VIEW FROM GRATITUDE WALL TO CHAPEL + MEMORIAL



0' 80' 100' | MEMORIAL PATH SITE SECTION | MEMORIAL | CHAPEL | GRATITUDE WALL

Claudia Contreras:

COLUMNS OF PRIDE

A VETERAN'S MEMORIAL CAN REPRESENT SO MANY DIFFERENT THINGS TO SO MANY DIFFERENT PEOPLE. WHETHER IT'S A DEEP SENSE OF PRIDE, A REPRESENTATION OF THE WARFIGHTER ETHOS, OR A PLACE TO REMEMBER THE GREATNESS OF THE PAST, IT IS ABOUT BRINGING PEOPLE TOGETHER.

AS ONE ARRIVES AT THE J.B. HUNT PARK, YOU CAN SEE THE INTEGRAL PART IT PLAYS IN THE COMMUNITY. THE ROLE OF THIS MEMORIAL IS TO GIVE THE COMMUNITY SOMETHING THAT GRABS THEIR ATTENTION, SOMETHING THEY CAN ADMIRE, BUT MOST IMPORTANTLY SOMETHING THAT LEAVES ITS MARK.

THE IDEA IS TO CREATE A FOREST OF COLUMNS THAT WELCOMES YOU WHETHER YOU DRIVE AROUND THE PERIMETER OR WALK UP ONE OF THE PARK TRAILS. THE COLUMNS ALLOW ONE TO IMMERSE THEMSELVES WITHIN THE MEMORIAL AND SEPARATE THEMSELVES FROM THE SURROUNDINGS. AS ONE APPROACHES THE MEMORIAL AND THE COLUMNS PULL YOU IN, THEY TAKE YOU ON A JOURNEY. AS YOU NEAR NAMES ENGRAVED IN STONE THE COLUMNS OPEN UP AND REVEAL SEVERAL GARDEN SPACES WHERE ADMIRERS CAN PAUSE TO TAKE IT ALL IN.

THE COLUMNS SYMBOLIZE OUR SOLDIERS (PAST, PRESENT AND FUTURE) WHO ALWAYS STAND TALL TO PROTECT THE FREEDOMS WE ENJOY. THEY SYMBOLIZE THE COMMUNITY WHERE PEOPLE SHARE THEIR OWN JOURNEY. AND FINALLY THE COLUMNS SYMBOLIZE US AS A NATION A COUNTRY OF IMMIGRANTS WHOSE CULTURES CREATED THE STONE FOUNDATION UPON WHICH THIS NATION WAS BUILT.

"GREATNESS IS NOT ABOUT US AS INDIVIDUALS, RATHER IT IS ABOUT US AS A UNIT, AS A TEAM, AS A GROUP, AS A COMMUNITY, AS A CITY, AS A COUNTY, AS A STATE, AS A NATION."



FLOOR PLAN DIAGRAM - NOT TO SCALE



COLUMN SAMPLE DIAGRAM



Robert E Buchanan:

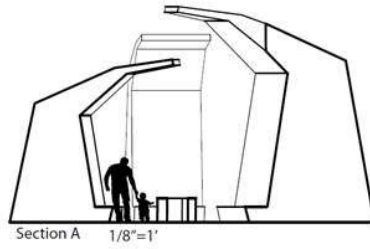
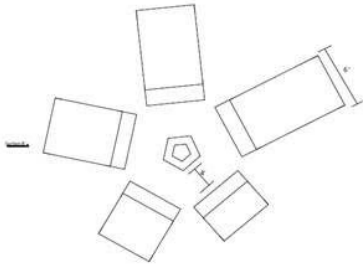

Jim Lastovica:



SPRINGDALE VETERANS MEMORIAL

PROGRAM STATEMENT:
THE PROPOSED VETERANS MEMORIAL WILL SERVE TO ENGAGE BOTH VETERANS AND CIVILIANS OF ALL AGES. PROVIDING MULTIPLE LEVELS OF INTERACTION AND EXPERIENCE WITHIN THE MEMORIAL SITE, VISITORS WILL BE ABLE TO WALK AWAY WITH A SENSE OF THE IMPORTANCE OF THE AMERICAN SOLDIER, REGARDLESS OF THEIR MILITARY BACKGROUND, AGE, ETHNIC BACKGROUND.

AS A BRIEF OVERVIEW, THE SITE WILL BE DIVIDED INTO TWO MAIN AREAS BY A LARGE WALL. THE SOUTHERN AREA WILL BE AN OPEN, PARK AREA TO BE ENJOYED BY VISITORS AND NEARBY RESIDENTS. WITH TREES, MEANDERING PATHS, A LARGE POND, AND STOPPING POINTS ALONG THE WAY, THIS AREA WILL INVITE FAMILIES TO COME AND ENJOY THE LAND, AND THE FREEDOM THAT COMES WITH BEING IN AMERICA. FREEDOM PURCHASED BY THE SACRIFICE OF THE VETERANS (WHO ARE NEVER FAR AWAY). TO THE NORTH OF THE WALL VISITORS ENTER THE MORE SACRED, CONTEMPLATIVE PORTION OF THE SITE, AND BEGIN TO UNDERSTAND THE COST OF THE FREEDOMS THEY ENJOY EVERY DAY.



SITE POCHE DIAGRAM
SCALE: 1/8"=1'

Jerry Lobato:

SPRINGDALE VETERANS MEMORIAL



ARTIST STATEMENT

The Folded American Flag is the most emotional symbol of patriotism, courage and honor for our military veterans and their families. It is how our great nation bestows its deepest gratitude, admiration and respect for their service and sacrifice. We are proud to make it our theme for this great memorial. Our Springdale Veteran's Memorial design is comprised of the Folded American Flag cast in bronze and mounted on a unique and elegant granite pedestal. The front panel provides ample space for a significant inscribed quote. We chose a famous Abraham Lincoln quote for your consideration. The sculpture will be installed in the center of 6 concentric rings gently rising from the landscape. A geometric pattern of multiple pathways leading to the memorial are handicapped friendly. The entire memorial has no stairways. The pinnacle of the memorial is surrounded by eight American Flags. Each flag will be anchored by a tall triangular granite pillar topped with a folded American Flag bronze with the specific military branch seal and historical plaque mounted on the front side of the pillar. Beyond the outer ring of the landscape will be a circular road for drive-by viewing, parking and handicapped access.

PROGRAM SUMMARY

Integrating a solemn and peaceful setting with many nearby multifaceted social and community uses such as ballfields and playground spaces can be a challenge. This site is well suited to compliment community energy and spirit. Creating an appropriate atmosphere for reflection with an intended respectful honoring of past, current and future veterans is important and desired on its own. Being available to visitors of all ages who will participate in the varied sport and family activities makes this Memorial location more special and viable. To enhance the Memorial site with a transition to respect and contemplate, we are envisioning additional complimentary features that can evolve over time. We suggest developing a landscape master plan and vision that includes outdoor art along with natural environmental zones that showcase native regional plants and trees. A small pond on the lower north end of the park can be integrated as one part of the educational nature walk. The dedicated gated driveway to the circular roundabout allows visitors to visit with their transportation of choice and appreciate the memorial with drive by viewing at different times and weather conditions. Night time lighting can be dramatic. Parallel handicap parking may be provided for easier access for older citizens. The memorial layout and design is intended to be constructed with minimum maintenance requirements. Long lasting material choices are suggested that will hopefully accomplish this important goal. Landscaping within the monument circular footprint is also understated with very little management needed. Budgets may ultimately dictate the qualities of various materials. We suggest a graduation to better natural materials as we enter the memorial circle. The Springdale Veterans Memorial is the community expression of thanks. It is a way to pay their respects and to remember the sacrifices of past veterans. The folded flag is an important symbol as it is given by our representative government to the family members of our fallen veterans. The focus of this memorial is the "bronze sculpture" of the folded flag. The bronze material is timeless and provides this folded flag a respectful symbol of importance and meaning. We appreciate the opportunity to suggest just one of many wonderful options you will consider.



perspectives

The traditional monument glorifies war and the people who fought, but perhaps this glory obscures the veteran's true experience, perpetuating a sense of distance between the veteran and society.

This memorial breaks the monument into two, one visible and proud, embodying the idealized understanding of war, and the other discreet and somber, expressing the real experience of those who serve.

the ideal

The Ideal stands as a monument in the traditional vein: prominent, visible, gleaming. In the open field, it is highly visible from the road, lots, and paths. But the glory only serves to obscure the soldier within, whom visitors can only catch passing glimpses of through narrow slots.

the real

Composed of the pieces removed from the Ideal and tucked amid the trees, the Real empathizes with the unseen reality that many veterans experience: the sacrifices made, the hardships endured, and the complex emotions that follow. Unlike the Ideal's obscured soldier, visitors are welcome to sit right beside the Real's slouching, human counterpart.



Jake Decker:

The Springdale Veterans Memorial Organization Competition

JB Hunt Park | Springdale, Arkansas | Rolling Gardens

INSPIRED BY A WAVING FLAG THE ROLLING HILLS OF THE PROPOSED J. B. HUNT PARK VETERAN MEMORIAL CREATE AN INTERACTIVE LANDSCAPE THAT IS TRANQUIL AND EYE CATCHING. AS THE RIBBONS STRETCH ACROSS THE SITE THEY RISE AND FALL EXPOSING TRANSLUCENT POLYCARBONATE MATERIAL THAT GLOWS RED, WHITE & BLUE IN THE NIGHT.

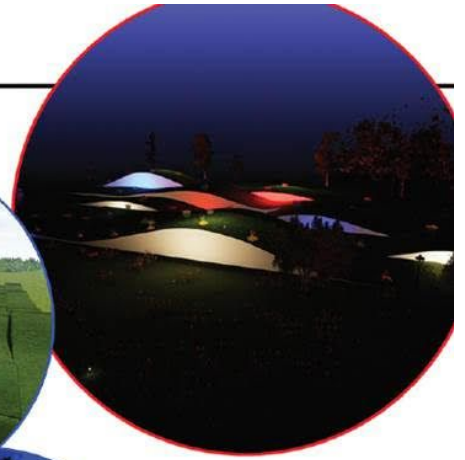
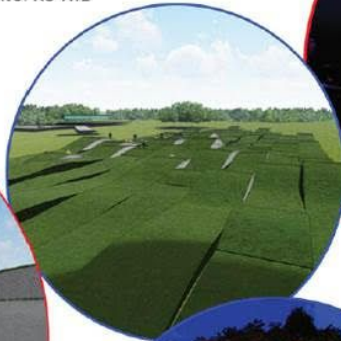
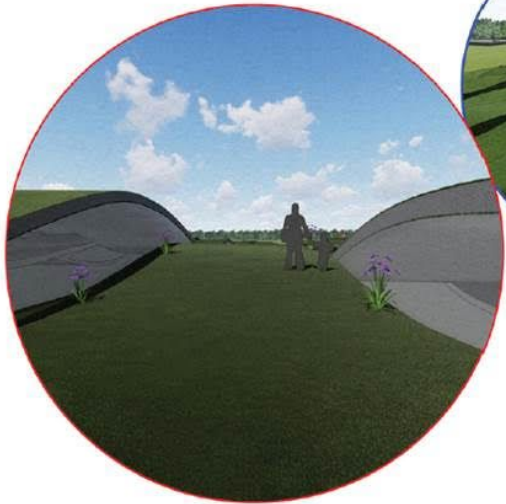
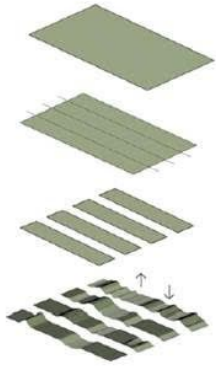

EAST ELEVATION

Thomas Laskaris:





SVMO Competition - April 30, 2020

the recordatio

SVMO Competition - April 30, 2020

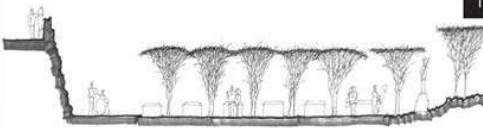
- 1** Wall & Procession - the recordatio site is bisected by a segmented retaining wall providing visitors direction and orientation within the site. Along the wall, opportunities for movement with presence, thoughtfulness, and contemplation greet visitors as they complete a timeline showcasing the sacrifices America's warriors have made since our nation's birth until today.

- 2** Field - An area of quiet solitude, an undulating meadow of tall grass measures the passage of time and the seasons. A rigid grid of light topped provides a rhythmic calming sequencing to an otherwise amorphous space.

- 3** Alleys - Beneath the landscape tree framed alleys, penetrated with bespeckled sunlight, culminate in statues of warriors representing the major epochs of American military history: Revolutionary War, Civil War, WWI, WWII, Korea, Vietnam & Southeast Asia, Persian Gulf War & The War on Terror. To educate, to remember, and to honor stone markers etched with important dates, battles and quotes highlight Springdale veteran's contributions during these campaigns.

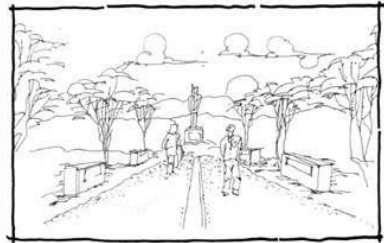
- 4** The Gathering - The act of remembrance commemorates itself as the personalized memories of our nation's warriors muster together in a collective group. Their shared brotherhood reveals itself in simple gestures of arm in arm, bent knees, and a lone tear easing down a worn face. A collective eye gazes towards a newer figure, an agent of those yet to serve. This form scrutinizes the recordatio.

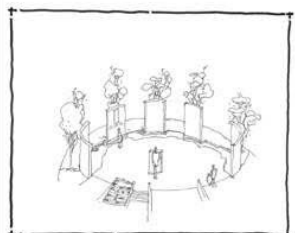
- 5** the recordatio is the culmination of the procession through the memorial, a place where Springdale veterans are individually memorialized. A series of obelisk type structures, representing the five branches of the military, stand quietly ready. As if being recalled from memory, pulsating lights cascade up the recordatios. Images of and information about Springdale veterans appear before fading into a haze of shimmering light.

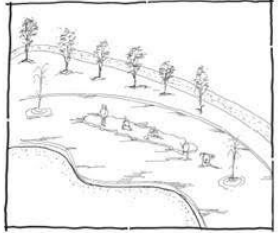

the recordatio

Karen Spense:



Rodrigo Carrillo:

A RIPPLE IN SERVICE

A Ripple in Service brings the community together with members of the armed forces, providing a space honoring those that make the life of freedom possible. The site is composed of a large central mound rising 9 feet in elevation that houses a Community Space at its precipice. The mound is surrounded by five 'cuts' within the Earth, each symbolizing the five branches of the US Military. The cuts contain a seating space that views toward rammed earth walls punctured with framed views of the Community Mound. Outside of these five 'cuts' are several hidden, private gathering spaces where people can get away to a more intimate experience for contemplation.

At the entrance to the Memorial one is greeted with 9 monumental steps leading up the mound, each inscribed with words of honor towards veterans. These inscribed steps are stitched together by a curvilinear path weaving in and out between them, providing an ADA accessible path up the Mound and allowing people to get out and read the inscriptions.

At the top of the Mound is our Community space. This zone is made up of clusters of 1, 2, and 3 foot high blocks mirroring the circular geometry of the site. These blocks are arranged to encourage interaction, creating multiple pockets of inhabitability, allowing groups to gather and converse. In the center of this space sits a reflective water table, placing a 'picture' of the sky into the mound. When not used as a space of reverence, this Community space allows space for kids to play and friends to gather.

From the 'Cuts', visitors have the chance to slip out to the forested edge at the site's perimeter, where they can experience meadows of native prairie grasses like little bluestem and indian grass, secret gathering spaces, and beautiful views of the park-like conditions surrounding the memorial and the surrounding community.



SITE AXON SHOWING MONUMENT AND SURROUNDING PARK

VIEW INSIDE OF RIPPLE IN EARTH



VIEW UP THE COMMUNITY MOUND



Brian Wells:

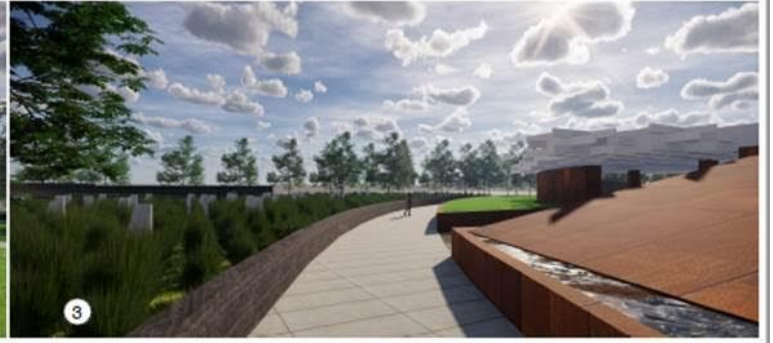

VETERANS FIELD

TO STAND IN HONOR, TO STAND IN SOLIDARITY, TO STAND AMONG YOU

What does it mean to be a veteran? How can a memorial convey the individual's pride, the sense of collective unity and strength that binds all veterans through an intangible spirit of service to the nation?

Our Springfield Veterans Memorial design tries to capture the unity of the individuals and connect it harmoniously to its home Park. We designed the memorial with a series of symbolic spaces that provide experiential quality to attract visitors, but also to provide a unique opportunity for veterans and a possible new generation to symbolically stand among those that have served the nation.

The memorial is an assembly of three spaces. The Donor's Path, where the names of contributing benefactors would be displayed, leading to The Reflection Pool, a space for remembering and contemplating. The Reflection Pool lightly touches the Apex of The Veterans Field, a series of monoliths standing in an ordered formation.

The basis of the design begins with the American flag, an ever-lasting symbol of the nation which the military serves. The memorial utilizes proportions of the flag in its rectangular configuration of The Veterans Field. Its corner was placed over to the two groves of trees on the site to allow for the apex and The Reflection Pool to be enclosed in the landscape, creating a serene contemplative space.

The Veterans Field is an ordered formation of monolithic standing thirteen rows wide by eighteen rows deep. The thirteen rows stand for the former symbolic stripes of the American flag and the eighteen rows numerically represent the current 18 million veterans in the US per the US Census. It is a number that will continue to be in flux but this memorial will be frozen in time commemorating the date of the completion.

The Veterans field starts with low monoliths at the north end of the site and gradually increases in height towards The Reflection Pool. The monoliths are representative of individuals who come from our communities and work together to be larger than themselves to represent the spirit of the nation. Depending on which way you choose to experience the field of monoliths, they either rise from the ground representing ascendancy to the military side or descend to represent an integration of the individual back into civilian life.



AERIAL VIEW



REFLECTION POOL - DAY VIEW



REFLECTION POOL - NIGHT VIEW



AMONG THE MONOLITHS



VETERANS FIELD



APEX

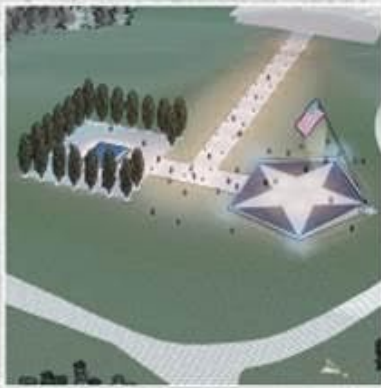

VICINITY PLAN



LOOKING NORTH

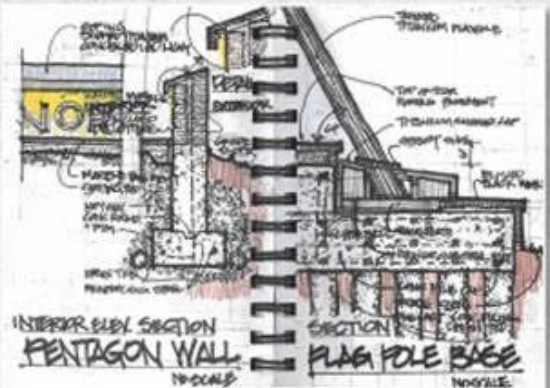

DESIGN DEVELOPMENT SKETCH



COLUMN NIGHT VIEW

DESIGN NARRATIVE

A historical budgeted with Local and State contributions. Built with Arkansas products.

Materials

- White marble: used in the floor of the star and walls of the pentagon. Unlike the same Arkansas marble which was quarried by Dale and the stone Jay Brothers in 1845, which was placed on the Washington Monument in Washington, D.C., from the quarry near Marble Falls, Arkansas.
- Arkansas black limestone marble: used in the floor of the star and the square water table is specified to be polished Arkansas marble.

Signifying

- It is expected that a local monument company would be subcontracted to make the suggested words of "COURAGE", "DUTY", "RESISTANCE", "SACRIFICE" on the interior walls of the pentagon as well as other prominent messages and dates as determined by the CMC and Community.
- The exterior face of the NW side of the pentagon wall, adjacent to Kanning Drive, would be treated with "4 X STUDY BASE".

Structure

- The sloped flagpole with its closed covered base, as well as the coping on the top of the pentagon walls is titanium, an exceptionally strong and maintenance-free material.
- The structure industry in Arkansas is at the forefront of developing plants and supplying this amazing metal in an increased global demand.

Precedents and design inspiration notes:

- The angle of the flagpole is set at 64°, reminiscent of the iconic World War II, Iwo Jima Memorial at Arlington National Cemetery.
- The slope of the pole ensures that the flag is dynamic even when the wind is a whisper. It is also vertically fixed at halfmast when the Nation is mourning.
- The structure flag pole and sleeve is set on a polished black marble base which contains a deep piling foundation to effectively resist high wind forces.
- The floor of the pentagon slopes to drain 1/8" per foot (from 8" to 0). The gentle slope accommodates that a lot of effort is required to walk or push a wheel chair towards the flag.
- The corners of the low walls of the pentagon are marked with like "sawtooth" lights. The coping walks the interior marble walls with continuous white light.
- The polished black marble "water table" is symbolically guarded by Italian Cypress (Cupressus) trees forming a triangular square courtyard. These cypresses symbolize the 48 stars before the signing of the Flag of the United States on Memorial Day.
- Water gently trickles out of the center of the table and uniformly sheets across the top, evenly spilling over the edges.

DESIGN NARRATIVE

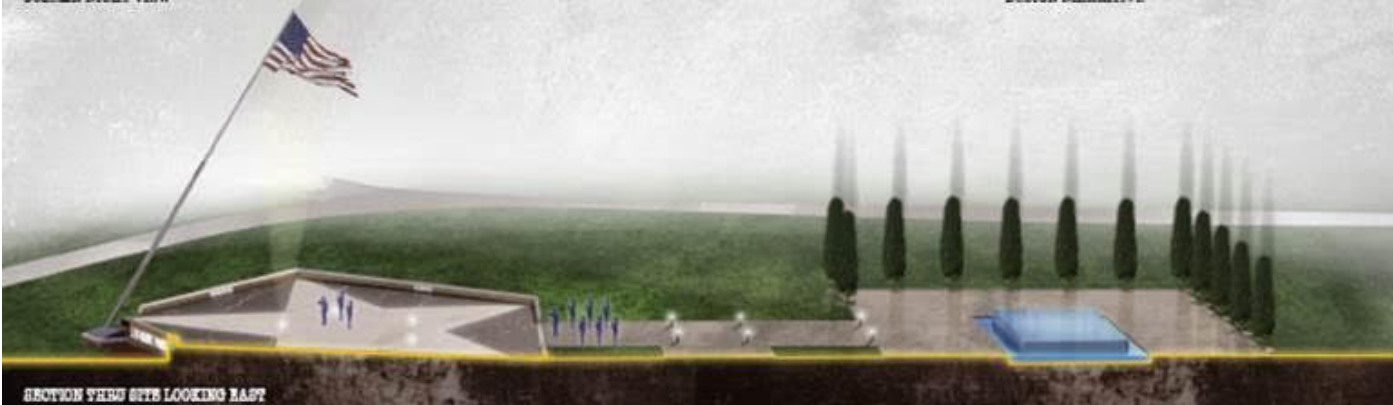

SECTION VIEW SITE LOOKING EAST

Sally Senn:

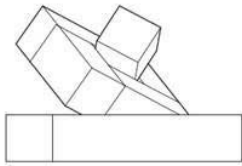
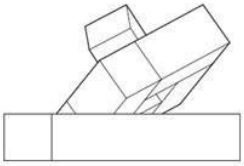
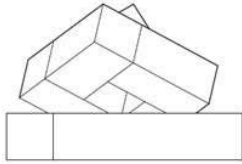
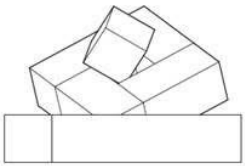
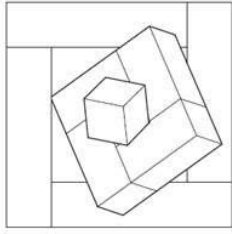
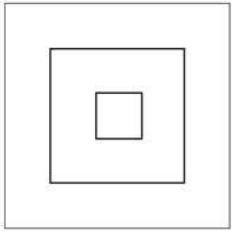

1/4th Inch scale



1/50th Inch Scale



Joiner Dotson:

Journey Through Service

Scale: 1"=20'

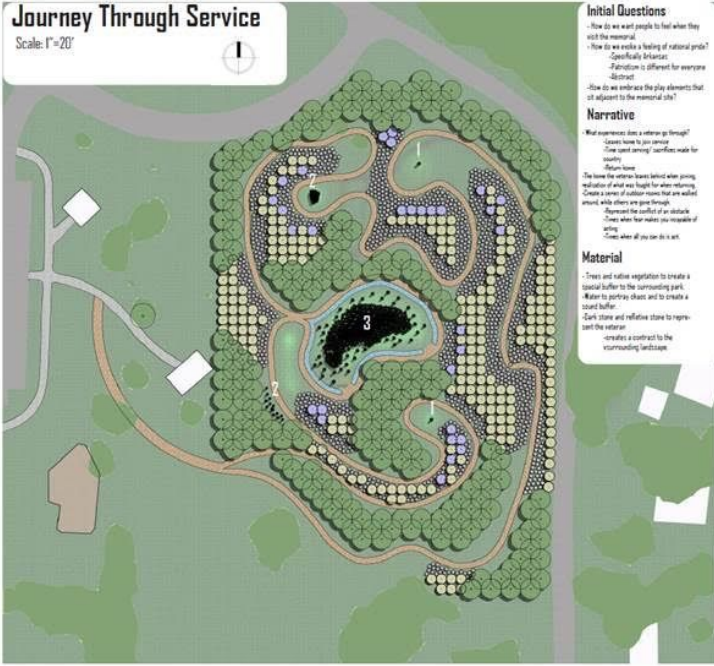

Initial Questions

- How do we want people to feel when they visit the memorial?
- How do we evoke a feeling of national pride?
- Specific behaviors:
- Activities is different for everyone
- Abstract
- How do we embrace the play elements that sit adjacent to the memorial site?

Narrative

What experience does a veteran go through?

- Counts down to join service
- One unit among hundreds made for unity
- Team work
- The love the veterans have behind when giving up their life for what they believe in
- Create a sense of national pride and a united front while others are gone through
- Remembrance and sacrifice of an individual
- They when their nation you capable of giving
- They when all you can do is act

Material

- Trees and native vegetation to create a special buffer to the surrounding park
- Water to provide shade and to create a quiet buffer
- Dark stone and reflective stone to represent the veterans
- Creates a contrast to the surrounding landscape

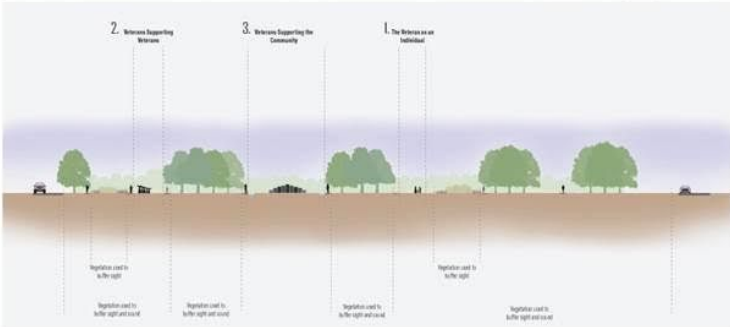

Experiences

You begin with a choice, along the path you encounter spaces conveying specific experiences veterans face on their journey through service.

The Individual



Veterans supporting Veterans



The individual submerging themselves into the comrade of service.



The support that veterans give the community

Laurence McMahon:

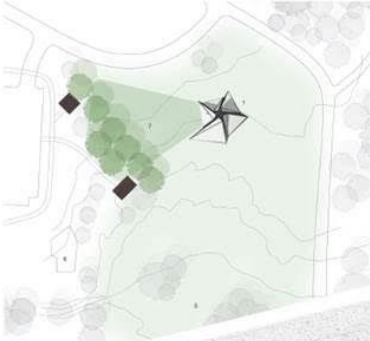

STELLAR ARRAY

This proposal for the Springdale Veterans Memorial was conceived as a primal, tectonic manipulation of the earth that creates a variety of spatial experiences to foster both individual contemplation and collective remembrance. Three simple elements define the site strategy - the stone figure of the memorial, a large gathering space to its west, and a bosque of trees that visually separates the memorial site from the restrooms and pavilion. Moving through the bosque onto the altered ground of the processional path and looking toward the enigmatic figure, each visitor is called to transition away from the pace and concerns of daily life to reflect on the sacrifices of many for our collective good.

The memorial's stone figure metaphorically pushes up from the strength of the ground beneath it, creating a variety of interior and exterior spaces around it. These faceted stone shards recall ancient cairns—stacked stone figures used to mark sites of remembrance and wayfinding; conspicuous on the horizon, they announce the memorial to driving, cycling and pedestrian passerby. The figure's generative star geometry references the five branches of the US Military and stars of the American flag. Five stone surfaces rotate around a single point and collectively form the star in the space between them. Though this symbol is ever present, it is only perceived from an aerial view. The materials are a simple palette of local limestone and slate, supported by a cast in place concrete structure. The contrasting tones of the limestone cladding the exterior surfaces of the memorial and the slate cladding the interior create a strong threshold into the most removed central space of the memorial—meant to foster a more intimate contemplative experience much like walking a labyrinth. VRemerging, the light exterior figure of the star radiates out into the landscape and creates spaces for larger groups of people. The collective and the individuals who make it up are inextricably linked.

The educational component of the memorial will include an educational augmented reality app, that would allow different inscriptions, AR veteran images, poetry and histories to be digitally written on the stone. This network of overlaid information will create an Easter egg hunt of discovering and opening various histories to as visitors explore various paths in and around the site.

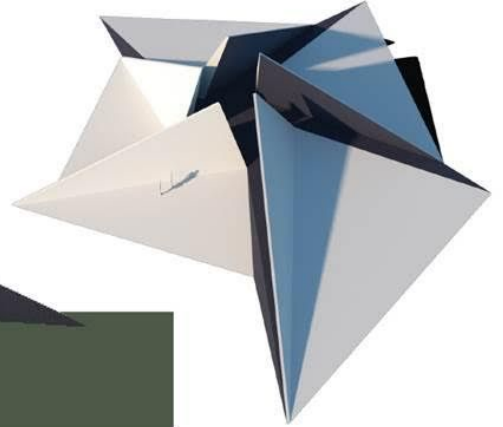
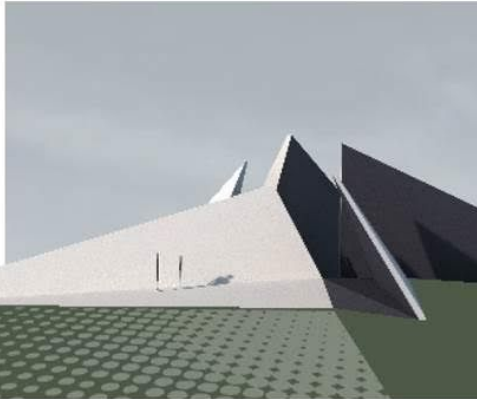

Roderick Cloud:

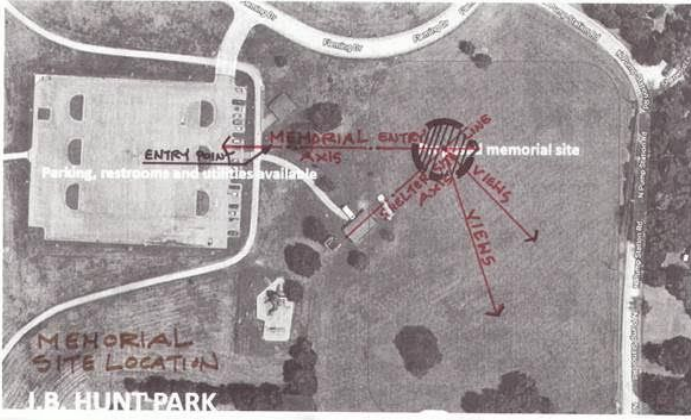

SPRINGDALE VETERANS MEMORIAL COMPETITION MEMORIAL DESIGN PLAN

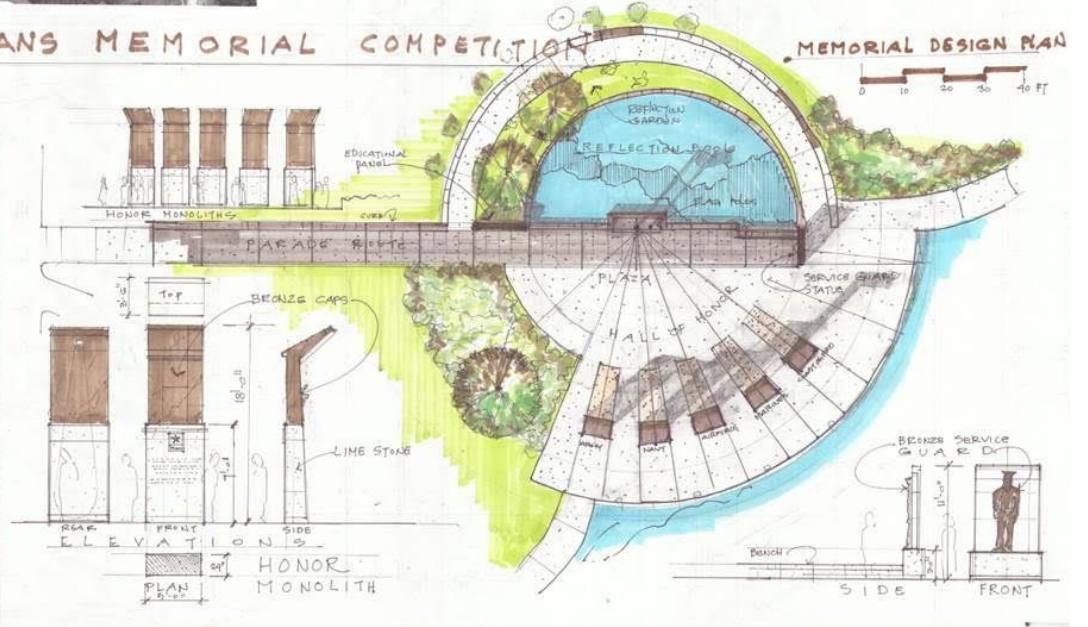

John Ivy:

Grounded by the Sky

"Grounded by the Sky" seeks to describe an imbalanced ellipse form that physically demonstrates the disconnect from loved ones felt by veterans while they are serving. The two sides of this landform are exact inverses of each other, with one rising above the existing ground level and one falling beneath it. Placed at each end is a stone with the inscription of a letter, one written to a veteran during their service, and their response placed on the opposite end. The side of the ellipse that descends downward into the earth is meant to symbolize the heavy undertaking of service, a burden carried both while serving and brought home through memories of the experience even after returning home. Meanwhile, the end of the ellipse that ascends above the earth symbolizes the relief and uplifting feeling of receiving a letter from home during serving. Placed at the moment of level ground between the two is a reflective channel that calls attention to the sky. Here a point of equilibrium is created that symbolizes the reconciliation between the two extremes. During an extended series of interviews with local veterans, one common theme revealed to us was the comfort and connection felt by looking up at the sky, knowing that regardless of where they were stationed or the amount of distance between them and their loved ones, they shared a view of the same sky. Accordingly the reflective channel that invites viewers to look up to the sky actively creates a connection between the inversed ends of the ellipse. Through this demonstration of disconnect and reconciliation, visiting veterans are provided with a space to feel understood in their unique experience, as well as a refuge and place of healing.



Ryan A. Doyle:



Stars and Stripes Springdale Veterans Memorial

PROJECT DESCRIPTION

We remember those we've lost through our actions here on Earth. The values they've taught us shape the world we create in their memory. It is up to each of us to find our own way, our own personal sense of duty. Yet we all are bound together as one nation.

Our common purpose is to cherish the freedoms we have defended, and secure that hope for the next generation. Through our differences we remain united. Our grief and loss go beyond any division or separateness.

We may never know all of what our veterans have sacrificed for us, but something in their spirit endures. In silence and light we can find our own answers, and discover that spirit lives within us.

Each day and season brings change - time does not stand still. Like our ancestors before us, we chart our course in the heavens, and find our compass within our hearts.

We come together as Americans to celebrate, to mourn, and to remember where we came from. We all feel the absence of those who are no longer with us. Their sacrifice has not been in vain, for it has built the foundation upon which we stand.

Aerial View



View upon arrival from the parking lot

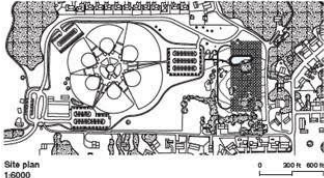

Site plan 1:6000

Memory Within A Garden

Memory is embedded in our landscapes. When visiting places such as the D-Day landing beaches of Normandy, France, one is surrounded by landscapes marked by history, filled with signs that make the experience of nature's beauty indissociable from the memory of the land's military past: structures scattered on beaches, bunkers sunken in the sand, barracks taken over by nature. These concrete fragments remind us of the sacrifices made by individuals who gave their all for an idea of freedom. The proposal aims to offer Springdale a place of emotional experience, where one can take the time to relax, to observe and to remember: a garden. For both the commemoration of a great military past and a celebration of the future of the community of Springdale, the garden is made of 2 parts: the orchard and the cloister.

The Orchard

The apple tree with its yield is a universal symbol of life and its blossom is the floral emblem of Arkansas. Two hundred trees are planted on the grounds of the current JB Hunt Park forming a large orchard to be shared by the Springdale community. Recognizing the courage of our service men and women and remembering the sacrifices they made for our great nation, each tree may be claimed to honor the life of a soldier by placing a commemorative plaque at its foot. As another means of generating revenue to support maintenance, inscribed pavers can be placed on the main path leading to the cloister, benches can be donated and new trees may be planted on the western side of the garden. The orchard will act as a place to both commemorate and celebrate life. It will draw Springdale citizens and others to enjoy apple picking in the Fall or walk between the blossoming trees in the Spring.



View of the orchard



View from N. Pump Station Road looking towards the memorial

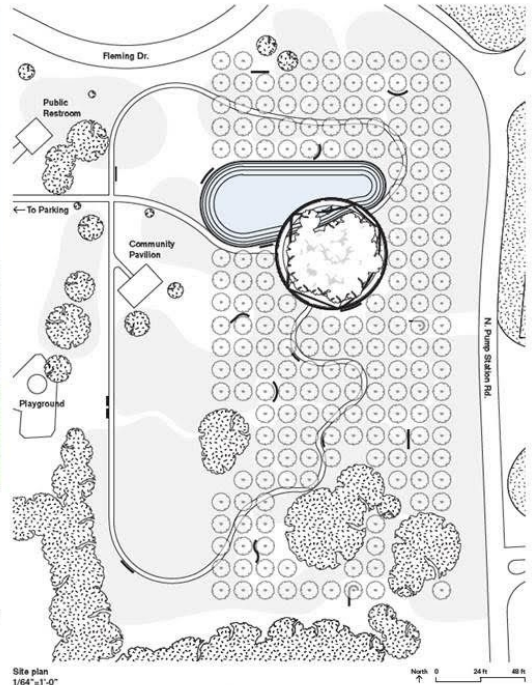

Site plan 1/64"=1'-0"

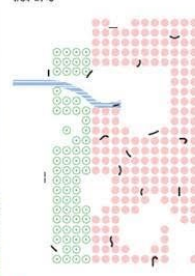

Revenue generation diagram

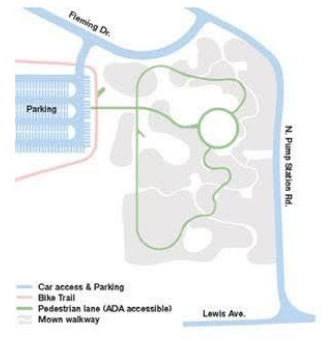

Access diagram

Naseem Alizadeh:



The proposal calls for the site to be utilized as allotment gardens for Springdale Veterans. The program approaches the site in a proactive manner: a place of commemoration, where the contributions of the Veterans can be acknowledged, but also a place that provides an opportunity to utilize the land in a productive and positive way. The project provides a covered (but open) community gathering space which can serve various functions, including a farmers' market. In addition, there are 18 individual allotment gardens, each with their own prefabricated storage/internal area that would have electricity and water. The elliptical shaped gardens would be fenced with charred cedar attached to a metal frame. The south side of each elliptical fence would only be 4' in height, to allow sunlight to enter the garden spaces, but on the north side, these fences would gradually rise to 8' in height.

The external areas around the allotments are designed to create opportunities for interaction. Benches are placed at strategic areas, and the site would be heavily planted with local, native trees and vegetation, in addition to wheelchair accessible (and color coded) public paths that weave through the site, establishing better connections between the residential area on the east side of N. Pump Station Road, and the park itself, in addition to providing opportunities for the Veterans to interact with each other and other community members who utilize the park. The overhead lighting along the paths occurs only on the western parts of the memorial garden, stopping short of the N. Pump Station Road so as to not create nighttime glare.

The project aims to find a balance between a private space for the Veterans to socialize and commemorate their sacrifices and achievements, but in addition, to provide a design and program that does not overwhelm the site through sculptural icon, but instead encourages the discovery of and movement through the park both by the Veterans who occupy the allotments, and the nearby neighbors and residents who are drawn to the park for recreational activities, thereby encouraging interaction and engagement between various demographics and age groups who share and enjoy the park space.

The program and design allow for an environmentally conscious use of the land, one that does not call for more grass, maintains permeability of the site, and takes advantage of rain water harvested on the site.



PLAN IMPOSED ON AERIAL: $\frac{1}{64}'' = 1'-0''$

SPRINGDALE VETERANS MEMORIAL ALLOTMENT GARDENS

Torrey Tracy:



SOJOURN
ribbon + amphitheatre

The centerpiece of the Sojourn experience, the ribbon sculpture recalls the act of fastening a yellow ribbon around a tree to commemorate a soldier's deployment. Here, the ribbon is in a constant state of unraveling—symbolizing that although some may not return, they are not forgotten; they have returned in spirit. Their bravery and service is immortalized in weathered metal on a still reflecting pool. This is a place for remembering, for honoring a permanent past.

This site easily accommodates events, ceremonies, and gatherings. The sculpture can creatively house audiovisual equipment for use in conjunction with the amphitheatre which embraces the reflecting pool. Etching on the sculpture's surface can memorialize veterans or honor donors. Similarly, the risers of the surrounding amphitheatre can display the names of those whose generosity made this community asset possible.



Native grasslands like the one pictured above were prevalent in Northwest Arkansas prior to European settlement. They are highly ecologically functional, low-maintenance, and beautiful.

planting: prairie

Surrounding the ribbon sculpture and amphitheatre in the northern half of the site is an native grassland sculpture and varied with native plant species. Planted in broad randomized sections, these screens are selected to provide varying color and textures from the dead of winter to the heat of summer.

Asplenium platyneuron Tussocks	Elymus virginicus Virginia wildrye	Panicum subulatum Boss grass
Asclepias syriaca Common milkweed	Helianthus annuus Common sunflower	Symphytum latifolium Carrollian fourtan mint
Lupinus albus White lupine	Kosteletia monnina Wingstem	Rudbeckia hirta Black-eyed Susan
Caltha palustris Yellow celandine	Sidalcea obovata Carroll Power	Mibodaphne aspartum Alle bluestem
Caltha palustris Purple Celandine	Dianthus spicatus Veining pink	Sibbannia scaberrima Compass plant

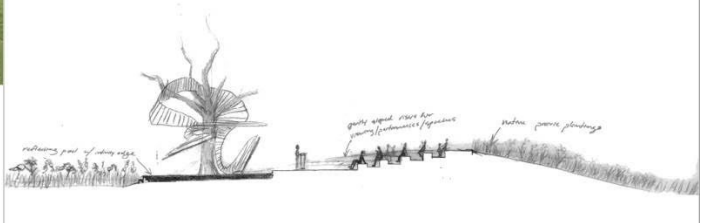

Sojourn is composed of two interconnected loops. At the northern loop, an expressive, tree-like metal sculpture memorializes our veterans, a symbol of the permanence of their collective sacrifice within history. At the southern loop, a quiet forest glade holds a living tree with sprawling branches arching gracefully over a reflecting pool, inviting visitors to the lively future which veterans' sacrifices made possible. At the intersection of these loops stands a flag pole, uniting past and present.

Surrounding the sweeping paths is a lush palette of native plants selected and placed to provide interest in every season. These bright blooms erupt from a blanket of meadow which fades into forest along the southern loop. Here, shade-loving plants populate the cool stillness of contemplative space.



RAMP OF HUBRISTIC PALIMPSEST

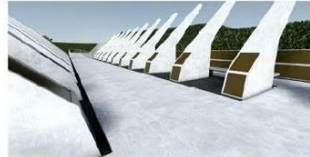

THE DYAD ANNEX



THE WALL OF MEMORIAL EDUCATION

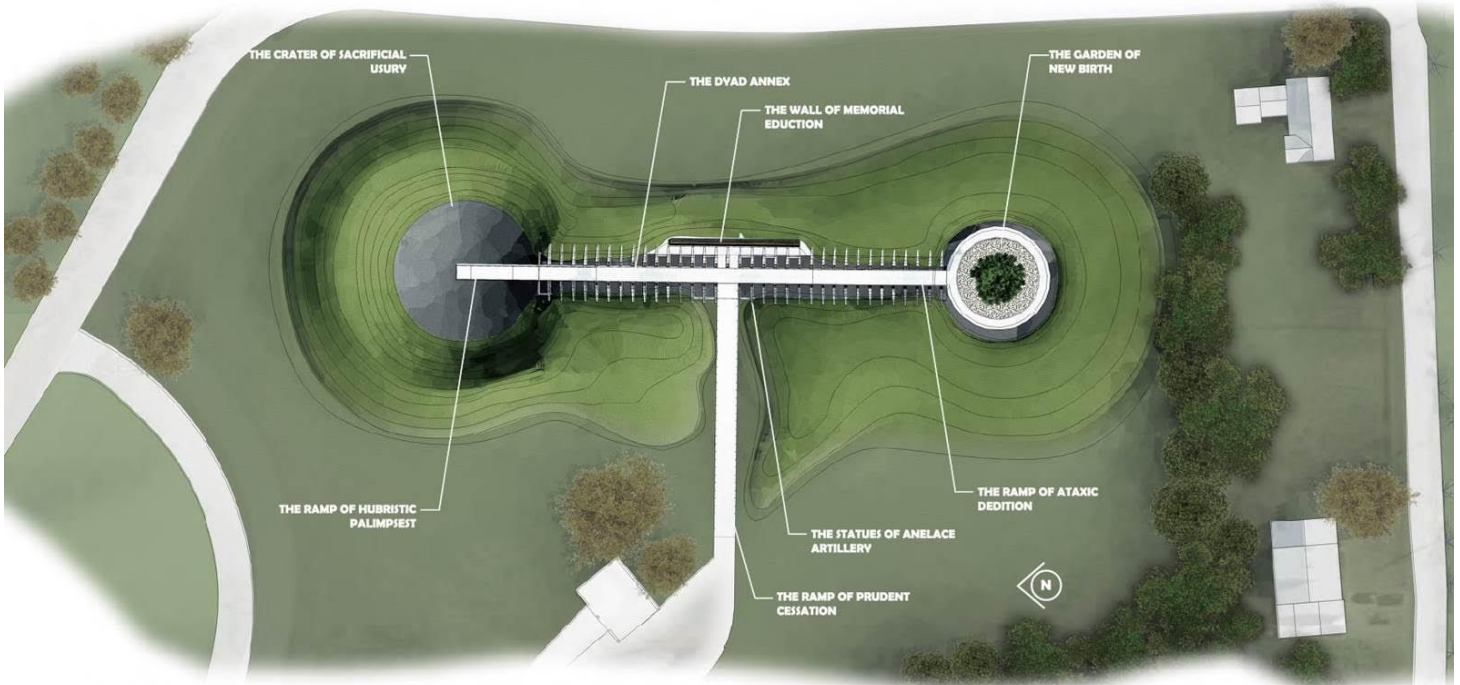

THE CRATER OF SACRIFICIAL USURY



THE GARDEN OF NEW BIRTH

Claudia Contreras:

COLUMNS OF PRIDE

A VETERANS MEMORIAL CAN REPRESENT SO MANY DIFFERENT THINGS TO SO MANY DIFFERENT PEOPLE. WHETHER IT'S A DEEP SENSE OF PRIDE, A REPRESENTATION OF THE WARFIGHTER ETHOS, OR A PLACE TO REMEMBER THE GREATNESS OF THE PAST, IT IS ABOUT BRINGING PEOPLE TOGETHER.

AS ONE ARRIVES AT THE J.B. HUNT PARK, YOU CAN SEE THE INTEGRAL PART IT PLAYS IN THE COMMUNITY. THE ROLE OF THIS MEMORIAL IS TO GIVE THE COMMUNITY SOMETHING THAT GRABS THEIR ATTENTION, SOMETHING THEY CAN ADMIRE, BUT MOST IMPORTANTLY SOMETHING THAT LEAVES ITS MARK.

THE IDEA IS TO CREATE A FOREST OF COLUMNS THAT WELCOMES YOU WHETHER YOU DRIVE AROUND THE PERIMETER OR WALK UP ONE OF THE PARK TRAILS. THE COLUMNS ALLOW ONE TO IMMERSE THEMSELVES WITHIN THE MEMORIAL AND SEPARATE THEMSELVES FROM THE SURROUNDINGS. AS ONE APPROACHES THE MEMORIAL AND THE COLUMNS PULL YOU IN, THEY TAKE YOU ON A JOURNEY. AS YOU NEAR NAMES ENGRAVED IN STONE THE COLUMNS OPEN UP AND REVEAL SEVERAL GARDEN SPACES WHERE ADMIRERS CAN PAUSE TO TAKE IT ALL IN.

THE COLUMNS SYMBOLIZE OUR SOLDIERS (PAST, PRESENT AND FUTURE) WHO ALWAYS STAND TALL TO PROTECT THE FREEDOMS WE ENJOY. THEY SYMBOLIZE THE COMMUNITY WHERE PEOPLE SHARE THEIR OWN JOURNEY. AND FINALLY THE COLUMNS SYMBOLIZE US AS A NATION A COUNTRY OF IMMIGRANTS WHO'S CULTURES CREATED THE STONE FOUNDATION UPON WHICH THIS NATION WAS BUILT.

"GREATNESS IS NOT ABOUT US AS INDIVIDUALS, RATHER IT IS ABOUT US AS A UNIT, AS A TEAM, AS A GROUP, AS A COMMUNITY, AS A CITY, AS A COUNTY, AS A STATE, AS A NATION."



FLOOR PLAN DIAGRAM - NOT TO SCALE



COLUMN SAMPLE DIAGRAM



Jordan Hines:

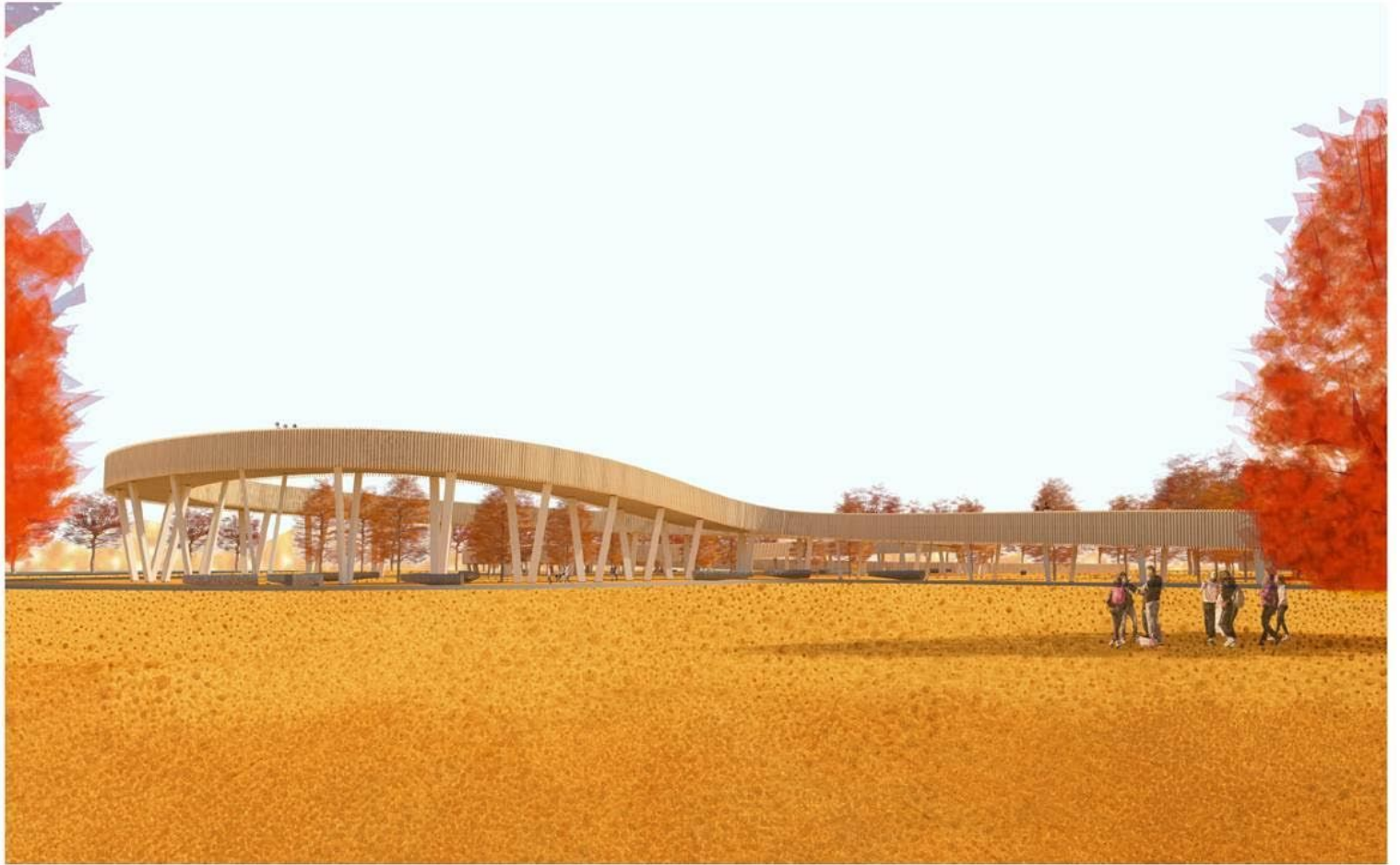

Springdale Veterans Memorial Trail

*Enhancing public space by honoring those who have, and continue to
serve our country.*

Kenneth Chad Hiley:

SPRINGDALE VETERANS MEMORIAL

This design concept for the Springdale Veterans Memorial seeks to embody the experience of American Veterans, and to be an enduring landmark of their legacies for generations to come.

As the site is currently used by individuals and families for recreational purposes, the scheme chooses to guard the perimeter of the open meadow rather than occupy it. One of the main strategies is to leave a degree of flexibility for the site, open to small gatherings, ceremonies, and services.

There are four primary architectural components to the project: The Entry Court, the Loggia, the Shadow Garden, and the Wing. Each plays a specific role in both the metaphorical and pragmatic aspects of the design.

The Entry Court is flanked by two large earth berms, each retained by board-formed concrete walls, and contains a colonnade of trees with seating. It is oriented toward J.B. Hunt Park and the adjacent parking lot, and provides visitors with a shady respite and landing zone. The left-most berm contains public restrooms and storage for the venue. The entry zone represents the new recruit, still green from life in the civilian realm.

From the Entry Court one moves underneath the Loggia, a 350 ft. canopy that runs laterally across the site. From this zone one may take in a panoramic view of the entire site, as well as access the Wing and Memorial. The south end of the Loggia would also function as a pavilion for small gatherings, a function present on the existing site, as well as a place for parents to monitor their children on the adjacent playground. The Loggia represents the linear nature of time as it connects the past, present, and future of the Memorial, Entry Court, and Wing.

The Shadow Garden is a reconfigured version of the Entry Courtyard. Instead of a colonnade of trees, it is composed of limestone monoliths which support a bronze parasol. Empty squares acknowledge the sacrifices of POW and MIA soldiers. The parasol guides one's eye upward, and represents the peace we enjoy because of those who came before us.

Across the field at the north edge of the site lies the final architectural element, the Wing. The Wing is a covered pavilion that is intended for use as a small stage. With the field in front of it to be used for seating, the Wing would host ceremonies, services, public speaking sessions, or even musical events. The Wing represents the future of the American Veteran, and the peace that comes through a strong commitment to freedom.



SITE PLAN LEGEND

1. ENTRY COURTYARD
2. PUBLIC RESTROOM
3. LOGGIA
4. REFLECTION POOL
5. SHADOW GARDEN
6. PLAYGROUND
7. WING PAVILION



100'